

OPTION-1
ON - ROAD JOINT BAY (DUAL DIRECTION CABLE INSTALLATION)
Scale 1:200

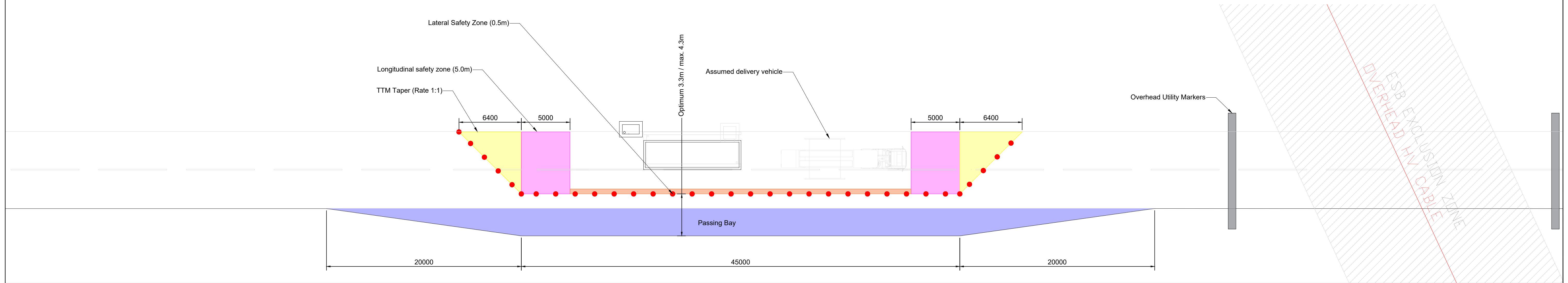

OPTION-2
ON - ROAD JOINT BAY (SINGLE DIRECTION CABLE INSTALLATION)
Scale 1:200

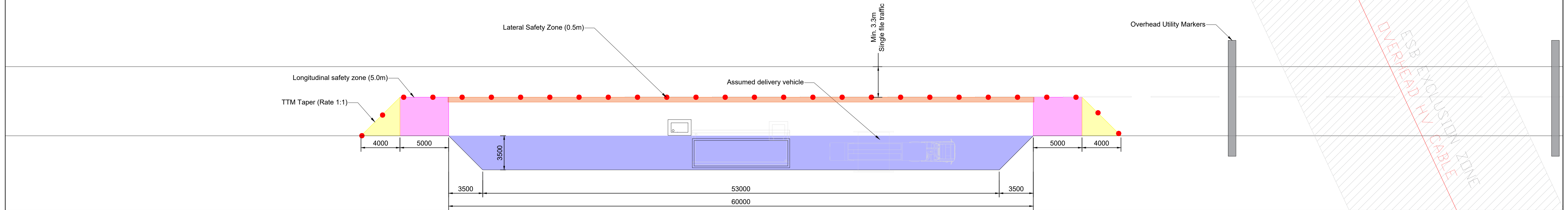

OFF - ROAD JOINT BAY
Scale 1:200

P02	06/04/23	Issued for Planning	VL	ES	Signet	AP	
P01	16/02/23	Issued for Planning	VL	ES	Signet	AP	
Rev	Rev. Date	Purpose of revision	Orig	Check'd	Rev'd	Apprv'd	
© Copyright 2023 Jacobs U.K. Limited. The concepts and information contained in this document are the property of Jacobs. Use or copying of this document in whole or in part without the written permission of Jacobs constitutes an infringement of copyright. Limitation: This drawing has been prepared on behalf of, and for the exclusive use of, Jacobs Client, and is subject to, and issued in accordance with, the provisions of the contract between Jacobs and the Client. Jacobs accepts no liability or responsibility whatsoever for, or in respect of, any use of, or reliance upon, this drawing by any third party.							

- NOTES**
- FOR PLANNING PURPOSES ONLY. NOT FOR CONSTRUCTION.
 - ALL DIMENSIONS ARE IN MILLIMETRES UNLESS OTHERWISE NOTED.
 - WHERE LEVELS ARE SHOWN, ALL LEVELS ARE IN METRES ABOVE MALIN HEAD DATUM.
 - THE LOCATIONS OF THE FOLLOWING ARE ILLUSTRATED INDICATIVELY; JOINT BAYS, TELECOMMUNICATIONS CHAMBERS, LINK BOXES, PASSING BAYS, HORIZONTAL DIRECTIONAL DRILLING AREAS AND LAYDOWN AREAS. FINAL LOCATIONS ARE SUBJECT TO DETAILED DESIGN.

REFERENCE DRAWINGS

LEGEND

- LONGITUDINAL SAFETY ZONE (5.0 M)
- TTM TAPER (RATE 1:1)
- PASSING BAY/CONSTRUCTION PLATFORM
- LATERAL SAFETY ZONE
- TRAFFIC MANAGEMENT - i.e. CONE

Jacobs
Merrion House, Merrion Road, Dublin, D04R2C5, Ireland
Phone: +353 (0)1 269 5666 Fax: +353 (0)1 269 5497
www.jacobs.com

Client

Project

EirGrid

KILDARE-MEATH GRID UPGRADE

Drawing title		JOINT BAY AND PASSING BAY ARRANGEMENTS PROPOSED DETAILS	
Drawing status		FOR PLANNING	Suitability S2
Scale	1:200	DO NOT SCALE	
Jacobs No.	321084AH	Rev	
Client No.	CP966	Rev	P02
Drawing number 321084AH-JAC-ZZ-XX-DR-K-2202			